

CHALET VILLA MEIDA POZZA DI FASSA

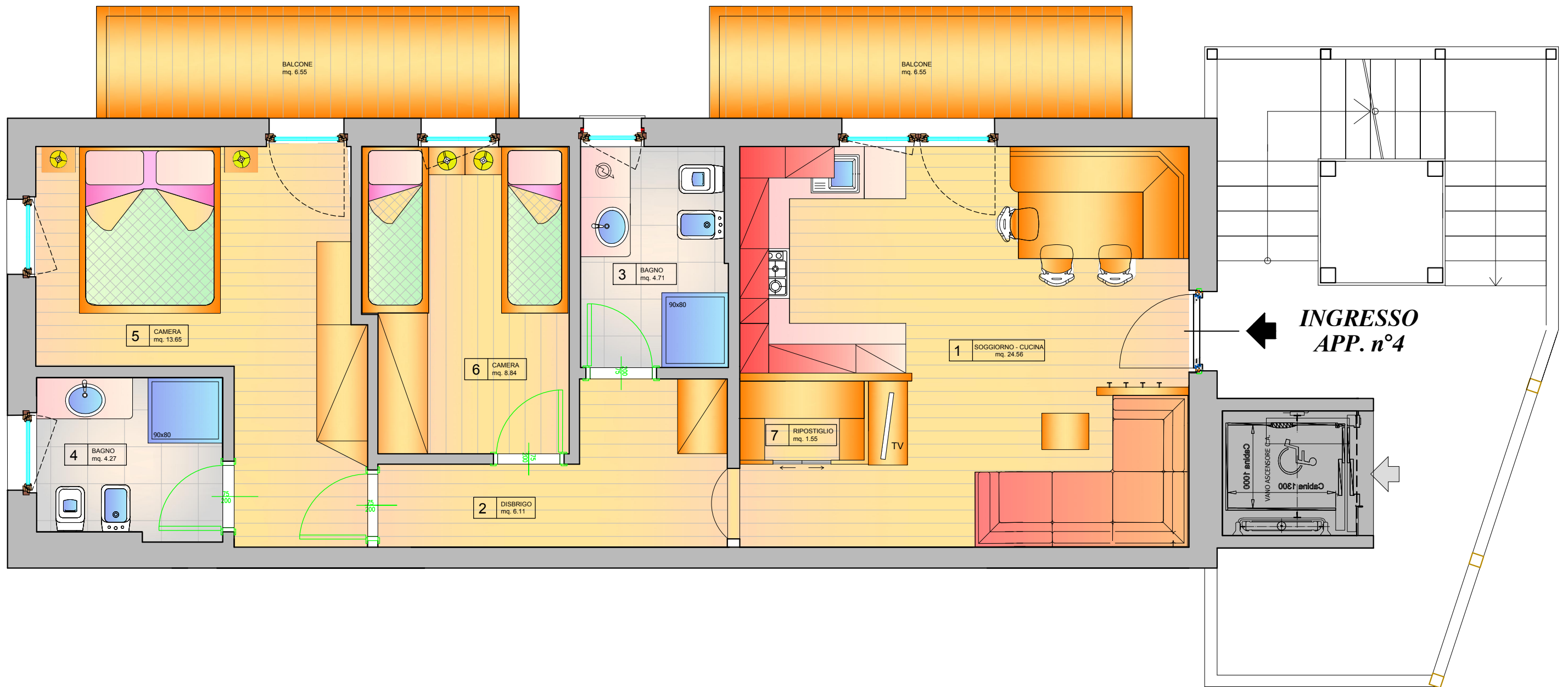

APPARTAMENTO n. 4 - PIANO PRIMO

	SUP. LORDE	COEFF.	SUP. COMM.
APPARTAMENTO	63.69 mq.	77.45 mq.	100%
POGGIOLI	13.11 mq.	--	50%
CANTINA	3.84 mq.	--	50%
GARAGE	12.50 mq.	--	50%
TOTALE			92.17mq.